



BDE Z32 Crossmember and ES Polyurethane Transmission Mount

6/22/2017

Parts List

Qty	
1	BDE Transmission Crossmember
1	Energy Suspension Polyurethane Transmission Mount
1	BDE Preload / Exhaust Hanger Bracket
2	7/16" bolts
2	7/16" flat washers
2	M10x1.25x16 Allen bolts

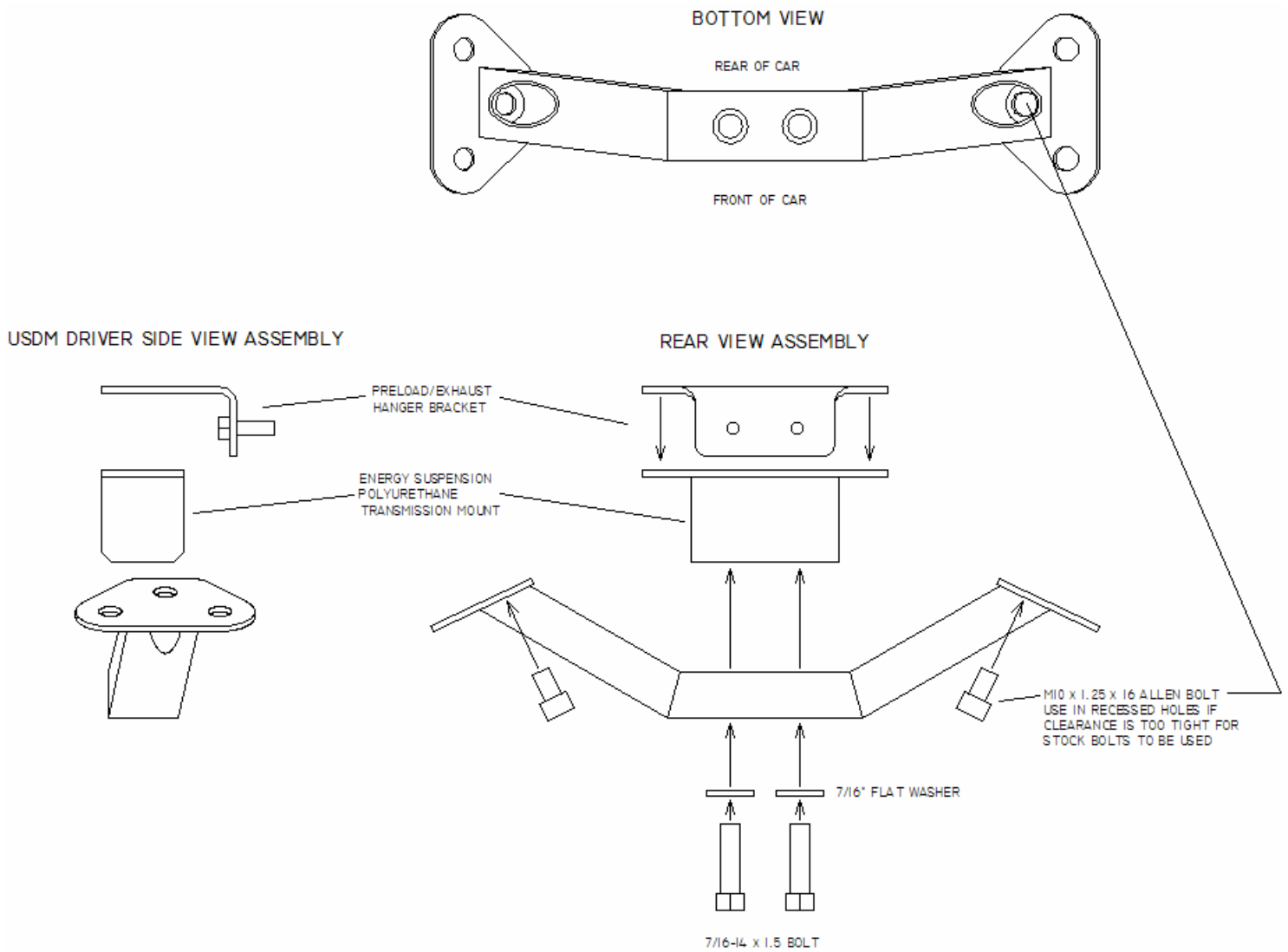

Special Tools Required

- Torque wrench
- 5/8" socket
- 8mm Allen wrench

Installation

- **First and most importantly, always apply oil or grease to all bolt threads prior to installing. This helps prevent damage to threads and ensures proper torque values.**
- To help with aligning everything, use a jack to hold the transmission's weight off of the assembly and install all bolts but leave semi-loose to allow adjustment. Only begin to tighten bolts after they have all been installed and the entire assembly is in position.
- Reuse your stock transmission to mount bolts and crossmember to chassis bolts.
- The Preload / Exhaust Hanger Bracket must be installed between the transmission and ES mount to properly preload the mount. Install the plate with the exhaust hanger bolts facing the rear of the car and hanging down from the transmission.
- Note, the ES mount has a bulge on one side but it makes no difference whether it is installed facing front or rear.
- Install the BDE crossmember with its three slotted holes on the passenger side (USDM) of the car.
- Due to chassis mount tolerance variations the stock bolts may not fit into the recessed mount holes. If the clearance is too tight for the stock bolts to be installed, use the supplied M10x1.25x16 Allen bolts in these positions.
- Don't forget to attach the ground wire from the transmission to one of the passenger side bolts.
- Torque the two BDE supplied 7/16" mount bolts to 35 ft-lbs. Torque all other bolts to the factory service manual specifications.